

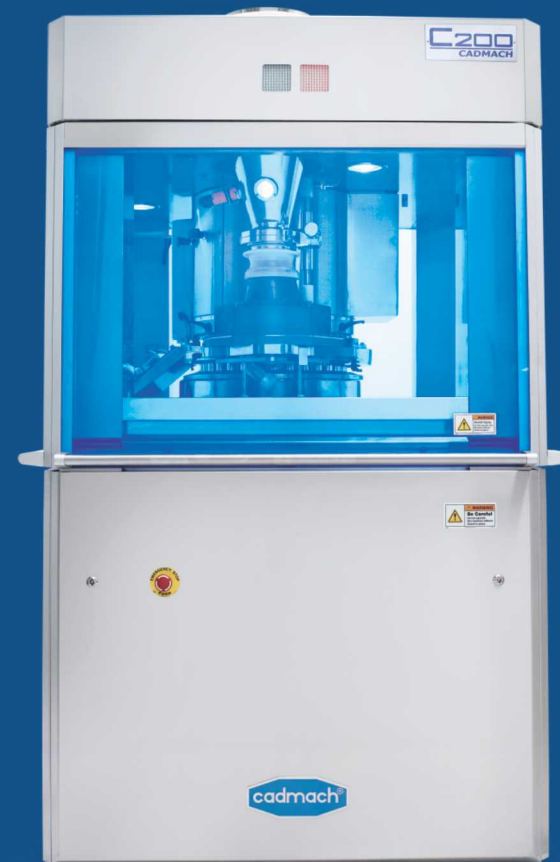

We **do more** for productivity

C 200 High-Speed Single Sided Tablet Press

The new dimension for performance and economy



Cadmach

Cadmach is part of a well established and successful corporation, incorporating global pharmaceutical and pharmaceutical machinery companies.

Since inception Cadmach established a high reputation for care & dedication by continuous innovation, quality & high standards of performance, resulting in substantial market shares in India, USA, Africa & various Asian and Middle East markets.

The Khambhatta family has been serving the Indian pharmaceutical industry for over 45 years and enjoys a high level of trust & confidence.

Several European & US companies value Cadmach as a reliable partner for marketing their products in India.

With an installed base of over 10,000 machines, Cadmach has accumulated the expertise and applications know-how to develop productive solutions with excellent economics.

Continuous pressure on profit margins and operational costs in the pharmaceutical industry require new concepts for reducing manufacturing-costs and CAPEX related to pharma machinery. Simultaneously plant availability and equipment effectiveness must be increased.



Mr. Pankaj R. Patel
Director Cadmach



Mr. Vinit Khambhatta
Director Cadmach



Mr. Ketan Khambhatta
Director Cadmach

Cadmach has taken this challenge & presents a newly developed range of high performance tablet presses incorporating industry's requirements for performance, quality & economics of investment.



Advanced Filling System

- User friendly assembly / disassembly without special tools
- Zero Clearance , 3 paddle force feeder for improved granule distribution and optimized filling
- ACVFD for high uniformity with different products
- Minimized product losses through advanced sealings
- High weight consistency at high speed

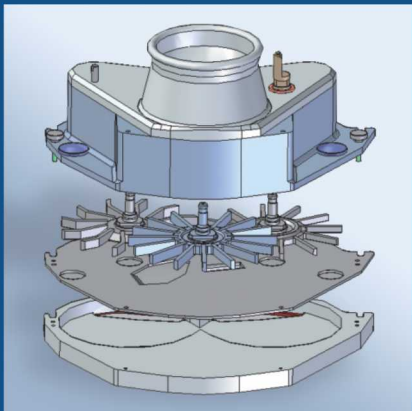

Features

- Exchangeable turret
- Ultra fast PLC control
- Automatic weight control through CFC
- Design conforming to cGMP & FDA
- Tablet output : Up to 206,400 Tablets / Hour
- 15" Touch screen operator panel
- Large range of accessories:
 - Uphill – deduster
 - Metal detector





We **do more** for productivity



Single Sided Tablet Press

- Main & Pre compression 100 kN

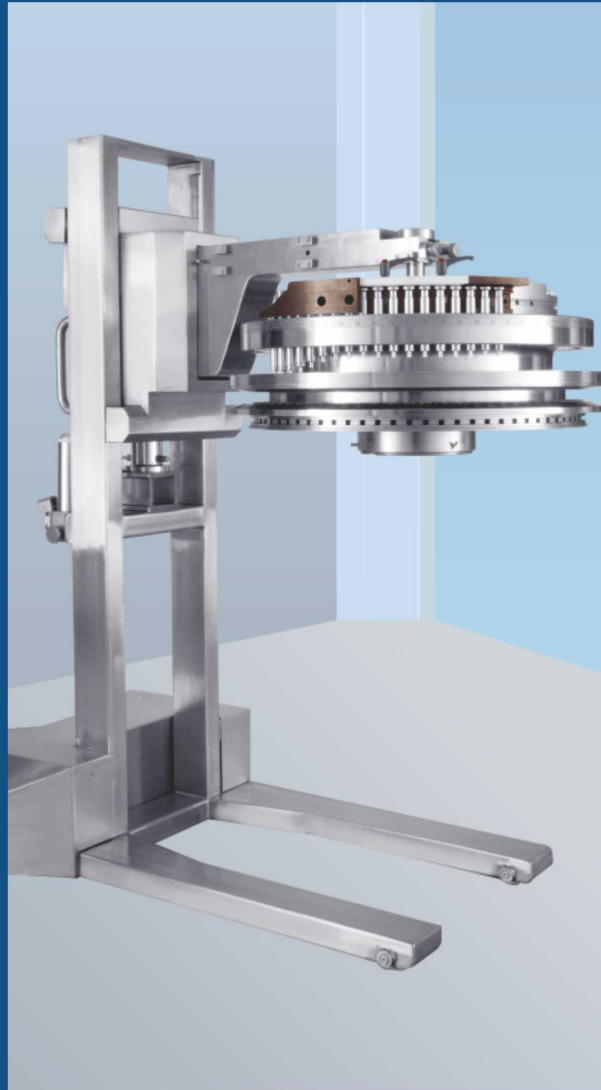

Turret for Improved OEE

- 3 piece turret for D, B & BB tooling
- Max turret speed 80 RPM
- Rapid format & product changeover
- Reduction of down time by using additional exchange turret
- Reduction of cleaning time
- Turret exchange does not require revalidation or qualification





Features

- Fully computerised machine based on CFC system
- Design conforming to cGMP and FDA Standards
- The machine is offered in three different turret configurations viz. 30 'D', 36 'B' & 43 'BB' stations
- Maximum turret speed - 80 rpm
- Tablet press designed with three piece interchangeable turret with upper & lower pc with electroless Nickel Plating & SS 316 Die table
- Equal capacity of Pre & Main compaction station (100 kN)
- Contact parts of SS 316 material
- Highest safety and monitoring
- Upper and lower doors with safety interlocks
- Force feeder with three paddles design to maintain the uniform filling
- Zero clearance force feeding system
- Stainless steel hopper with butterfly valves & powder level monitoring system
- Lower punch scraper seals
- Central auto lubrication system for tools
- Significantly reduced noise level
- Simplicity of operation, operator safety and easy to maintenance
- Rapid format and product changeover resulting in high annual yields
- Large window allow access from all four sides
- Ejection assembly position sensor
- Lower cam track size & position identification sensing device
- Easy accessibility allows quick cleaning & fast product change over
- All tablet parameters can be fine tuned through touch screen & displayed



We **do more** for productivity

Control Features

- 15" Touch screen operator panel
- Stainless steel computer control panel
- Auto weight control through CFC system
- Precise single tablet rejection (Bad tablet) via comp. force even at high speed of operation
- 21 CFR Part 11 Compliance
- Pre & Main comp. force monitoring system
- Ejection force mechanism
- Lower punch stiffness measurement system
- Upper punch stiffness measurement system
- 3 level password security to prevent unauthorised use of the m/c & different operation access rights facility
- Machine auto set-up (In respect to tablet parameter)
- Initial machine Start-up & Stop tablet rejection
- Tablet sampling device
- Recipe management
- Recipe parameters
- Batch documentation / Printing option
- Machine status alarms



Technical Specification

MACHINE TYPE	C 200 - 30 D	C 200 - 36 B	C 200 - 43 BB
No. of station	30	36	43
Type of tooling	D	B	BB
Max. rated output (tablets / hour) *	144,000	172,800	206,400
Min. rated output (tablets / hour) *	18,000	21,600	25,800
Turret speed (rpm)	10 - 80		
Max. compaction force-Main (kN)	100		
Max. compaction force-Pre (kN)	100		
Max. tablet diameter (mm)	25	16	13
Max. depth of die fill (mm)	20	18	
Max. tablet thickness (mm)	8.5		
Upper punch penetration (mm) (Main & Pre Comp.)	1 to 4		
Main ele. motor (kW / hp)	11.0 / 15		
Power consumption (kW / hp)	15.0 / 20.0		
Power supply	220 / 380 / 415 / 480 V ±10%, 3 Ph., 50 / 60 Hz		
Overall dimensions (cm)	158 W x 143 D x 208.5 H		
Net weight (kg)	3920		
Case dimensions (cm)	198 W x 177 D x 238 H		
Gross weight (kg)	4310		

* Depending upon tooling size & shape and also material characteristics.
- We reserve rights of alteration because of technical progress.

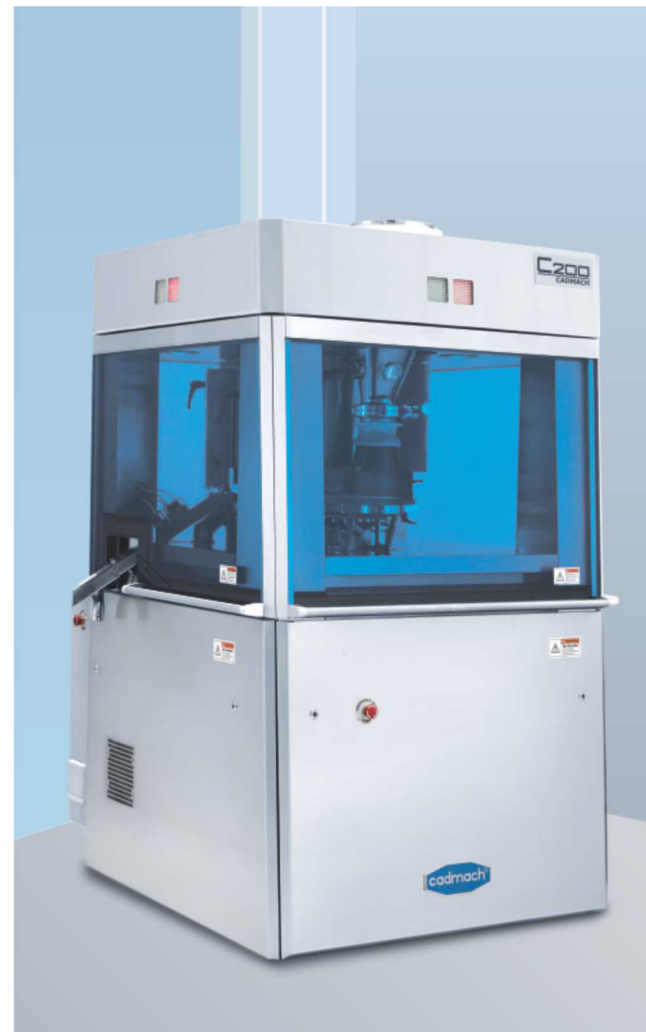



We **do more** for productivity

Foot Print

GENERAL ARRANGEMENT

- 1** Anti-vibration mounting
- 2** S.S. Lower guards
- 3** Acrylic Upper guards
- 4** Hopper
- 5** Discharging chute
- 6** Cooling fan with wire mesh
- 7** Machine light
- 8** Emergency stop push button
- 9** Dust extraction outlet nozzle (Ø2-1/2"OD)
- 10** Computerized control panel
- 11** Operator terminal with 15" Touch screen
- 12** Separate electric panel box
- 13** Air inlet
- 14** Inbuilt electric panel box (Swing type)
- 15** Main switch

Note

1. All dimensions are in millimeter.
2. Minimum space required for installation of the Machine.
Width = 610 cm (20') (With Computerised Control Panel & Separate Electric panel Box)
Depth = 487 cm (16')
Height = 365 cm (12')

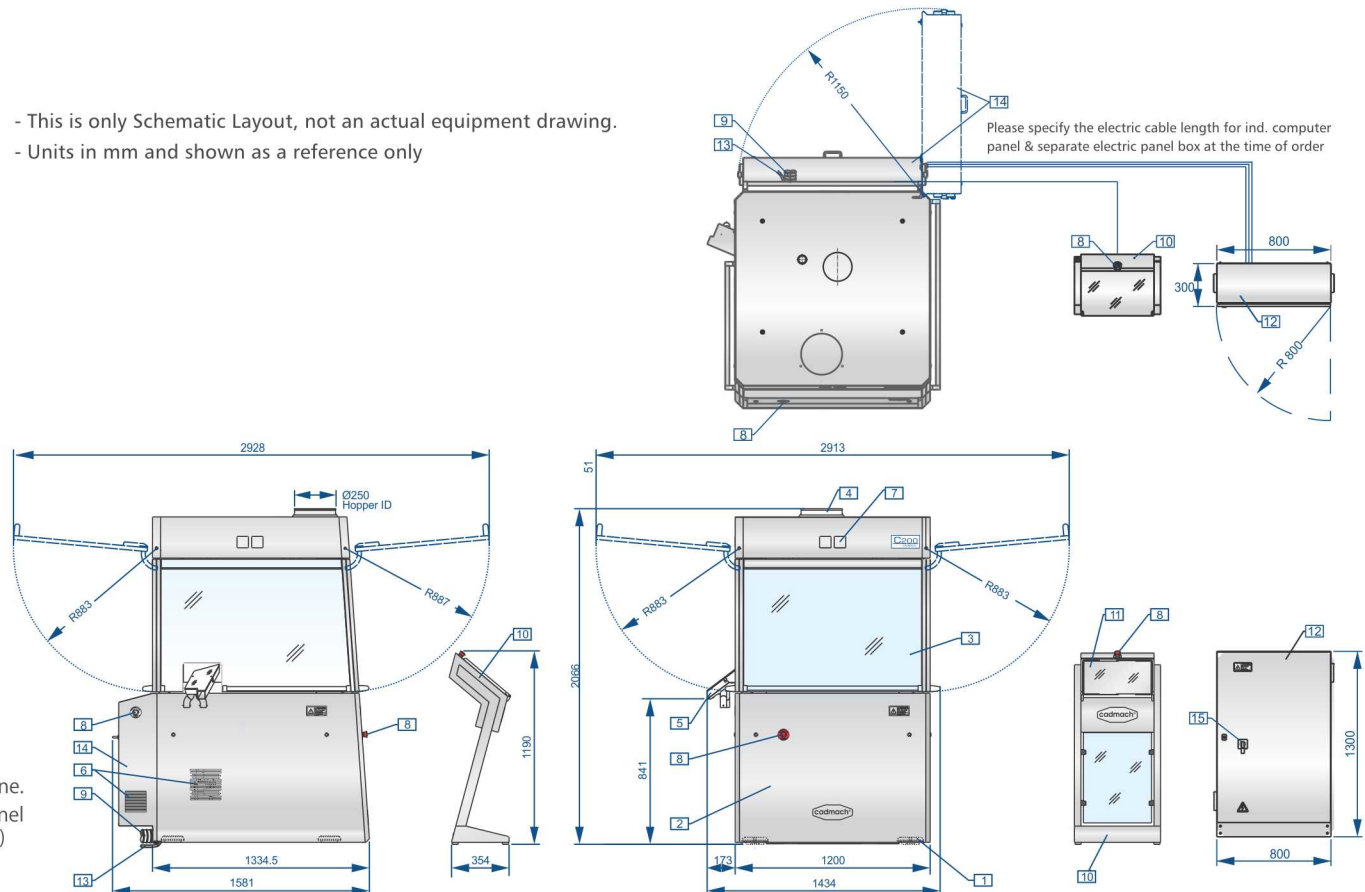



We **do more** for productivity

Cadmach Technology Center

Service / Maintenance

- Mechatronics qualified service engineers

Scope of Services

- Installation
- Commissioning
- Validation
- Maintenance
- Calibration
- Customizing

Training

Individual training programs tailored to customer's requirement



HEAD OFFICE & PLANT INDIA

Plot No. 3604 & 3605, GIDC, Phase IV, Vatva,
Ahmedabad 382 445. INDIA.

Phone : +91 79 2584 1491 / 92 / 93
Fax : +91 79 2584 2602
E-mail : info@cadmach.com
Web : www.cadmach.com

CMC MACHINERY LLC USA

743 Alexander Road, Suite # 5, Princeton,
NJ 08540. USA.

Phone : +1 609 720 9800
Fax : +1 609 720 9810
E-mail : salesusa@cmcmach.com
Web : www.cadmachamerica.com