

**Customer Centric • Flexible • Innovative**

**Syringes, Dosers and on-demand devices**

[info@althenamedical.it](mailto:info@althenamedical.it)  
[www.althenamedical.it](http://www.althenamedical.it)

## OUR SERVICES

- ◆ Design
- ◆ Assembly
- ◆ Filling
- ◆ Sterilization
- ◆ Blister Packaging
- ◆ Packaging

## OUR APPLICATION FIELDS

- ◆ Aesthetic Medicine
- ◆ Ophthalmology
- ◆ Orthopedics
- ◆ Home Drug Administration





## QUALITY CONTROL

Quality checks and meticulous attention throughout device production are at the core of our organization. Every device we produce reflects who we are. Inspections and testing are carried out by trained and qualified staff to ensure the highest standards.

We have implemented advanced machinery enabling precise inspection and evaluation of components, ensuring finished product compliance and supporting design and development studies.

## FACILITIES & CERTIFICATION

- **ISO 13485:2016** certified since 2017
- Syringes **assembled and blistered** in **ISO 7 cleanroom**
- **ISO 5 filling cleanroom operational in 2026**

## OUR R&D DEPARTMENT

We internally design, test, and validate both the machines and tools used for device production and assembly. This allows us to significantly reduce both costs and lead times.



**Althena Medical** develops and manufactures syringes and droppers for the pharmaceutical industry starting either from standard products or from the client's specific requirements.

We are **customer-centric** , **flexible** , and **innovative** .

We adapt to the unique needs of each project, putting people at the center and delivering dynamic, forward-thinking solutions.

We bring your device from concept to market in months, not years.



READY TO MARKET

HOW WE WORK



NEEDS



Robust • Ergonomic • Transparent

## Pre-fillable COP Syringe

Sycare is fully **customizable** in volume, colour and shape.

### AVAILABLE VOLUMES

0.5 ml	5.0 ml
1.0 ml	8.5 ml
1.0 ml long	10.0 ml
2.5 ml	20.0 ml - Flanged option available
3.0 ml	50.0 ml - Flanged option available

## WHY COP?

- Superior plunger glide
- Impact resistant Glass-like transparency
- Lighter than glass
- Allows easy formation of various shapes Does not release ions
- Constant pH Eco-friendly

Althena Medical offers label application on the Barrel and the option to mold a personalized logo on the Finger Grip.



## Oral liquid dispenser

Unique system for precise dosing  
in just three steps

- Available now in 5ml volume
- Available soon in 10ml volume
- 0.5 ml increments



### 1 Dose



### 2 Set



### 3 Memorize



### Volume Selection System

- **Adjustable volumes** – Set up to 5.0 ml in 0.5 ml increments.
- **Ergonomic** – Easy to handle.
- **Easy volume reset** – Quickly set the desired dose.
- **Error-free** – Perfect for repeated dosing.
- **No constant checks** – Volume remains set for each administration.
- **Click alert** when dose is accurately set.

### Easy to use

- **Simple internal cleaning.**
- **Gentle** on the mouth.

### Designed to prevent medicine wastage

- **Nospillage** – Medication stays inside.
- **Zero waste** – Every dose counts.
- **Exact dose** – Precision guaranteed.

### Adapter for Bottle Attachment

- **Leak-free** device – Adapter stays secure.
- **Click alert** when Adapter is correctly attached.
- Adapter provided as a separate component.

# Misyri

Low-dose single-use syringe

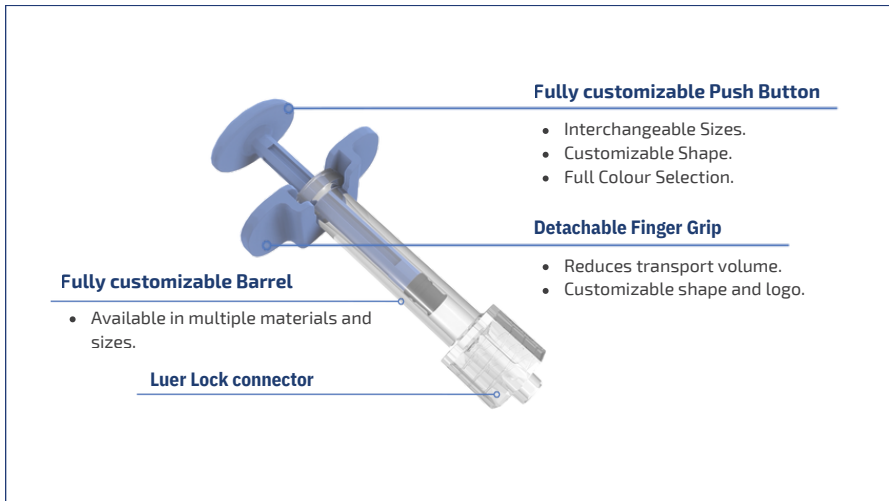

Volumes up to  
0.2 ml!

- **Ideal for Ophthalmic application**
- **Effortless vaccination.** Enables children to be vaccinated easily.
- **Compact & Portable.** Space-saving design reduces product and plastic waste.
- **Silicon-free option available**
- All our devices can be customized in terms of shape and colour, according to the specific needs of the client.

## Zero dead space

Designed to minimize the dead space between the plunger and needle, ensuring complete delivery of the active pharmaceutical ingredient and reducing dose loss.



- **Polycarbonate Finger Grip**
- **Barrel available in:**  
**Cyclo Olefin Polymer and Polycarbonate**

**UNDER DEVELOPMENT**

# Sy pure

Transparent•Durable•High purity

## COP Syringe for clinical and hospital use

High Performance – Ideal for filling:

- Biopharmaceuticals
- Intravenous solutions
- Ophthalmic drugs

### DEVICE TESTING

- Microscopic Counting of Sub-Visible Particles
- Bioburden
- LAL TEST (Quantitative Turbidimetric Method)
- Shelf Life
- Sterility
- Physicochemical Tests\_PhEU10.0\_3.3.8.
- Sterile single-use plastic syringe

The frequency and type of tests applied can be adjusted according to the customer's requirements and the intended purpose of the finished product.

**Assembly in an ISO 7 cleanroom** minimizes particulate and bioburden residues, ensuring very low endotoxin levels after sterilization.

**ISO 7 Cleanroom for molding will be operational in 2026.**



### AVAILABLE VOLUMES

0.5 ml

1.0 ml

1.0 ml long

2.5 ml

3.0 ml

5.0 ml

8.5 ml

10.0 ml

20.0 ml - Flanged option available

50.0 ml - Flanged option available

# Helidose

Accurate and rapid dosing

Patented system 

## Pre-filled multidose syringe for liquid and viscous solutions

Multidose device with pre-set and  
memory functions for volume dispensing.

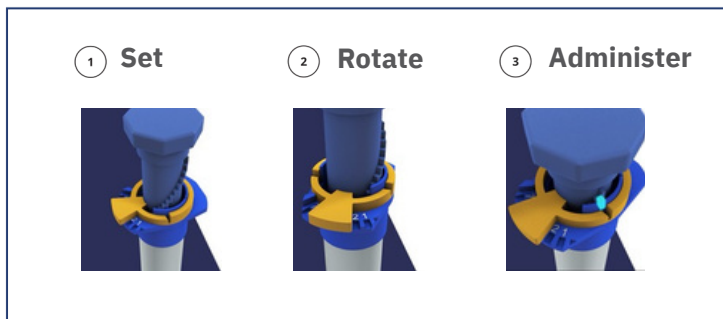

- **Dose repetition made easy**  
– simply rotate the plunger.  
**Pre-memorized dose** for  
• error-free administration.

- **Push** the plunger to  
administer the dose.

- **Set** the dose.

- The **ring stops** the  
plunger's rotation.

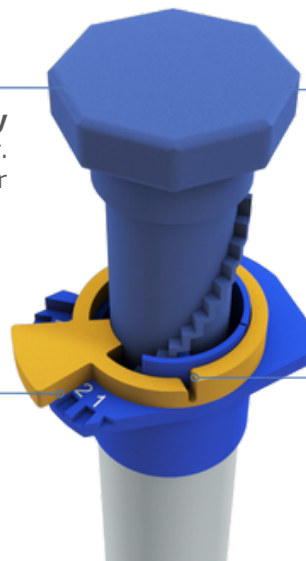

**UNDER DEVELOPMENT**

# Dual Chamber syringe: combination products



Designed to provide **stability** and **convenience** for biopharmaceuticals that require reconstitution before administration. They can significantly reduce the number of handling steps and therefore the probability of preparation errors by patients or caregivers.

## Pre-filled Dual-Chamber Syringe for Pre-Mixing and Delivery

## Pre-filled Dual-Chamber Syringe for Sequential Liquid Delivery

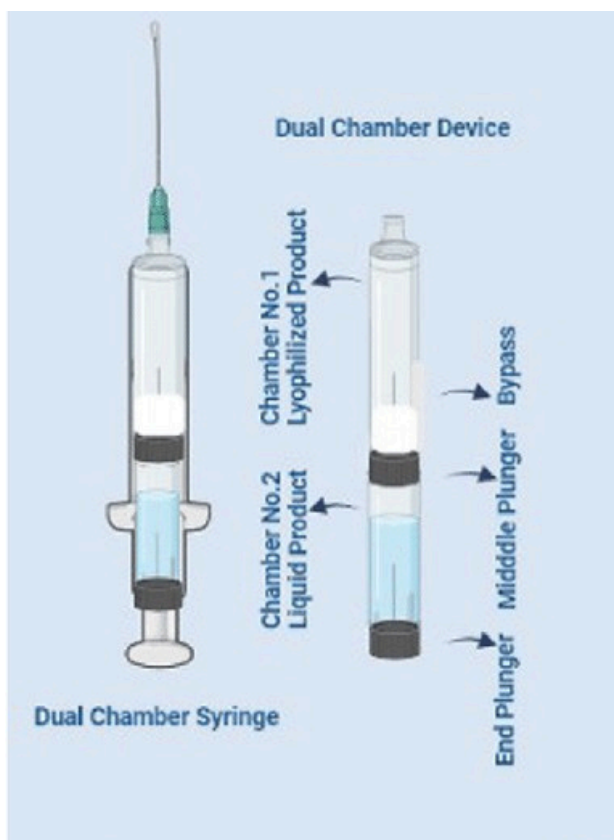

AVAILABLE  
VOLUMES

3.0 ml  
5.0 ml  
10.0 ml



Contact us  
to request a **Free**  
Feasibility Study



**Althena Medical is a brand of  
Platinum Pharma Service  
ISO 13485:2016**

**Legal and Operational HQ:**

Strada Lungofino,187 c/o Centro Ibisco, Modules C13-C16  
65013 Città Sant'Angelo - Pescara, Italy.



**[www.althenamedical.it](http://www.althenamedical.it)**  
[info@platinumpharmaservice.it](mailto:info@platinumpharmaservice.it)  
[info@althenamedical.it](mailto:info@althenamedical.it)